

17TH FLOOR PLAN OF BLOCK A1
(SCALE 1:100)

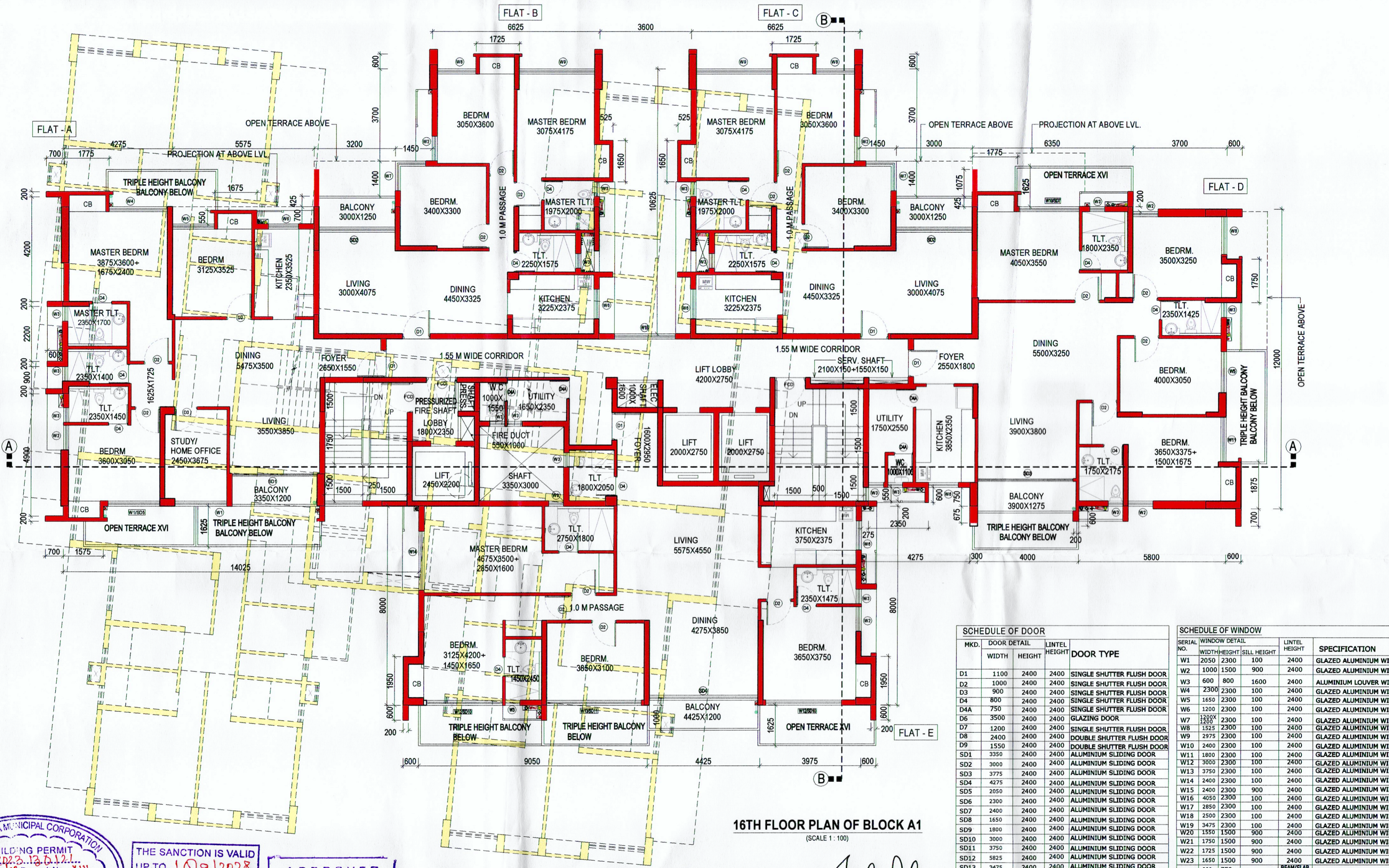

16TH FLOOR PLAN OF BLOCK A1
(SCALE 1:100)

MKD.	DOOR DETAIL	LINTEL HEIGHT	DOOR TYPE	
D1	1100	2400	2400	SINGLE SHUTTER FLUSH DOOR
D2	1000	2400	2400	SINGLE SHUTTER FLUSH DOOR
D3	900	2400	2400	SINGLE SHUTTER FLUSH DOOR
D4	800	2400	2400	SINGLE SHUTTER FLUSH DOOR
DA	750	2400	2400	SINGLE SHUTTER FLUSH DOOR
DB	3500	2400	2400	GLAZING DOOR
D7	1200	2400	2400	SINGLE SHUTTER FLUSH DOOR
D8	2400	2400	2400	DOUBLE SHUTTER FLUSH DOOR
D9	1550	2400	2400	DOUBLE SHUTTER FLUSH DOOR
SD1	3350	2400	2400	ALUMINIUM SLIDING DOOR
SD2	3000	2400	2400	ALUMINIUM SLIDING DOOR
SD3	3775	2400	2400	ALUMINIUM SLIDING DOOR
SD4	4275	2400	2400	ALUMINIUM SLIDING DOOR
SD5	2950	2400	2400	ALUMINIUM SLIDING DOOR
SD6	2300	2400	2400	ALUMINIUM SLIDING DOOR
SD7	2400	2400	2400	ALUMINIUM SLIDING DOOR
SD8	1650	2400	2400	ALUMINIUM SLIDING DOOR
SD9	1800	2400	2400	ALUMINIUM SLIDING DOOR
SD10	3000	2400	2400	ALUMINIUM SLIDING DOOR
SD11	3750	2400	2400	ALUMINIUM SLIDING DOOR
SD12	3825	2400	2400	ALUMINIUM SLIDING DOOR
SD13	3475	2400	2400	ALUMINIUM SLIDING DOOR
SD14	2850	2400	2400	ALUMINIUM SLIDING DOOR
SD15	2500	2400	2400	ALUMINIUM SLIDING DOOR
SD17	1475	2400	2400	ALUMINIUM SLIDING DOOR
SD18	3575	2400	2400	ALUMINIUM SLIDING DOOR
PCD	1200	2400	2400	SINGLE SHUTTER FIRE CHK. DOOR

SERIAL NO.	WINDOW DETAIL	WIDTH	HEIGHT	LINTEL HEIGHT	SPECIFICATION
W1	2050	2300	100	2400	GLAZED ALUMINIUM WINDOW
W2	1000	1500	900	2400	GLAZED ALUMINIUM WINDOW
W3	600	800	1600	2400	ALUMINIUM LOUVER WINDOW
W4	2300	2300	100	2400	GLAZED ALUMINIUM WINDOW
W5	1650	2300	100	2400	GLAZED ALUMINIUM WINDOW
W6	1500	2300	100	2400	GLAZED ALUMINIUM WINDOW
W7	1500	2300	100	2400	GLAZED ALUMINIUM WINDOW
W8	1525	2300	100	2400	GLAZED ALUMINIUM WINDOW
W9	2975	2300	100	2400	GLAZED ALUMINIUM WINDOW
W10	2400	2300	100	2400	GLAZED ALUMINIUM WINDOW
W11	1800	2300	100	2400	GLAZED ALUMINIUM WINDOW
W12	3000	2300	100	2400	GLAZED ALUMINIUM WINDOW
W13	3750	2300	100	2400	GLAZED ALUMINIUM WINDOW
W14	2400	2300	100	2400	GLAZED ALUMINIUM WINDOW
W15	2400	2300	900	2400	GLAZED ALUMINIUM WINDOW
W16	4250	2300	100	2400	GLAZED ALUMINIUM WINDOW
W17	2850	2300	100	2400	GLAZED ALUMINIUM WINDOW
W18	2500	2300	100	2400	GLAZED ALUMINIUM WINDOW
W19	3475	2300	100	2400	GLAZED ALUMINIUM WINDOW
W20	1550	1500	900	2400	GLAZED ALUMINIUM WINDOW
W21	1350	1500	900	2400	GLAZED ALUMINIUM WINDOW
W22	1725	1500	900	2400	GLAZED ALUMINIUM WINDOW
W23	1650	1500	900	2400	GLAZED ALUMINIUM WINDOW
V1	900	750	-	2400	ALUMINIUM LOUVER WINDOW
V2	2500	750	-	2400	ALUMINIUM LOUVER WINDOW

BUILDING PERMIT
No. 2022.12.01.11
Date: 11.11.2022, Borough No. XIII

THE SANCTION IS VALID
UP TO 11.11.2022

APPROVED
ASSISTANT ENGINEER (C)
BOROUGH No. XIII

DECLARATION BY OWNER & ARCHITECT
I CERTIFY THAT THE BUILDING PLAN HAS BEEN DRAWN UP AS PER PROVISION OF K.M.C. BUILDING RULE 2009 AS AMENDED FROM TIME TO TIME. THE SITE CONDITION INCLUDING THE WIDTH OF THE ABUTTING K.M.C. ROAD OF AVG. 10.05 M. ON EAST HAS BEEN CONFIRMED WITH THE PLAN. IT IS A BUILDABLE SITE, NOT A TANK OR FILLED UP TANK. SITE MEASUREMENT IS AS PER REGISTERED BOUNDARY DECLARATION.

DECLARATION BY STRUCTURAL ENGINEER
THE STRUCTURAL DESIGNS AND DRAWINGS OF BOTH FOUNDATION AND SUPERSTRUCTURE OF THE BUILDING HAS BEEN MADE BY ME CONSIDERING THE SOIL TEST REPORT (AS PER THESE RULES AND THE REGULATIONS MADE UNDER THE ACT) MADE BY MR. J. PAUL FROM SKM GEOSURVEY AND ALSO CONSIDERING ALL POSSIBLE LOADS INCLUDING THE SEISMIC LOAD AS PER NATIONAL BUILDING CODE OF INDIA AND CERTIFY THAT IT IS SAFE AND STABLE IN ALL RESPECTS.

PROJECT
RESIDENTIAL BUILDING U/R 394 OF KMC FOR PROPOSED BLOCKS A1 & A2 B+(G+18) STORED AND EXISTING BLOCKS B1 & B2, B+(G+17) & A3 AND A4 (G+19) STORED HIGH RESIDENTIAL BUILDING AT 88 A, B.L.SAHA ROAD, BOROUGH NO. - XIII, WARD NO. - 116, KOLKATA - 700053 VIDE BS NO. 2017130170, DT 01.12.2017 AND 20/U/R-26(2a) AND (2b)/2019-2020 dt - 03/12/2019

NOTES
- ALL DIMENSIONS ARE IN MM
- ALL EXTERNAL WALLS ARE 200 THK. AND ALL INTERNAL WALLS ARE 100MM AND 125MM THK BRICK WALL, UNLESS OTHERWISE MENTIONED.
- ALL P.C.C. WORK IN 1:3:6
- ALL R.C.C. WORK IN 1:2:4
- ALL OTHER SPECIFICATIONS CONFORMING RELEVANT I.S.I. CODE
- INTERNAL ROAD LEVELS ARE (+)150 MM FROM

signature of Architect
Sanjay Mandal
COA Registration No.: CA / 98 / 23621

signature of Owner
For Sugam Griha Nirman Ltd.
Chokrasingh
Director
For Self and as Constituted Authority of
1. Orbit Towers Pvt. Ltd.
2. Goodluck Infra Developers Pvt. Ltd.
3. Super Diamond Nirman Pvt. Ltd.

SIGNATURE OF STRUCTURAL ENGINEER
M. K. ROY
B. C. E. (Indrapur), M. Sc. TECH. (Manchester), U.K.
A. M. C. S. T. C. ENG. M. I. STRUCT. E. (London)
Membership No. 20108950
KMC Empanelled Structural Reviewer
E. S. R. - (I) 6/12

SIGNATURE OF STRUCTURAL REVIEWER
JISHNU PAI
B.Tech (Civil), M.E (Geo-tech)
KMC Reg. No. G.T/1/132
GTER/NKDA/10/0043
22/R/S/ROW/G.T/1/2018-17
HMC Reg. No. EGT/CLASS-1/15

ARCHITECT
26/2 Ballygunge Circular Road,
Kolkata 700019
www.innatendia.com
tel: (033) 4000 6424 / 25 26
This drawing is the property of M/s INNATE and might not be copied or lent without the express consent of M/s INNATE.